

Happy D.2 Washbasin # 2318600000 / 2318600027

| < 600 mm > |

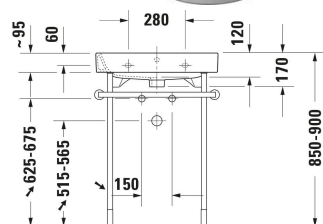
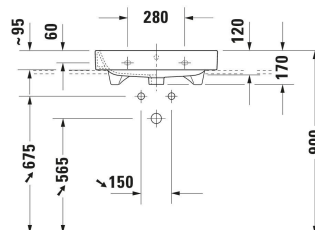
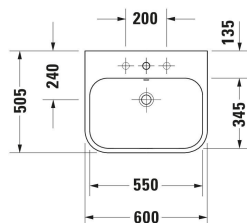

Washbasin	Dimension	Weight	Order number
Rectangular, Tap hole platform: Yes, Overflow: Yes, Incl. overflow clip, Underside glazed, Back side glazed: No, 600 mm, Internal dimensions: 550x345 mm			
Colors			
00 White Alpin			
Variant			
● White High Gloss, Number of washing areas: 1 Middle, Number of faucet holes per wash area: 1 Middle	600x505 mm	16.700 kg	2318600000
● White High Gloss, Number of washing areas: 1 Middle, Number of faucet holes per wash area: 1 Middle, Ground	600x505 mm	16.700 kg	2318600027
Infobox			
Space-saving siphon is recommended in conjunction with vanity unit			
Sanitary ceramics with the special WonderGliss surface finish will remain clean and attractive-looking for a long time to come. When ordering WonderGliss please add a "1" as eleventh digit to the model number.			
Accessory			
Push-open waste Suitable for washbasin with overflow, Ø 63,5 mm	Ø 63.5 mm	0.34 kg	005052
Design siphon Material: Brass, Outlet drain: horizontal, Suitable for Washbasin	76 x 483 mm	1.5 kg	005036
Suitable products			

Happy D.2 Washbasin # 2318600000 / 2318600027

| < 600 mm > |

Metal console Chrome, Type of mounting: Floorstanding, Wall installation, Height adjustable: 50 mm, Incl. mounting material: Yes, Reversible: No, Incl. towel rail: Yes, 573 x 491 mm	573 x 491 mm	003028
Console vanity unit wall-mounted Number of drawers: 1, Incl. console: No, Without handle, Soft self-closing automatic with damping, Lay-in compartment Optional, 800 x 548 mm	800 x 548 mm	DS5312
Console vanity unit wall-mounted Number of drawers: 1, Incl. console: No, Without handle, Soft self-closing automatic with damping, Lay-in compartment Optional, 900 x 548 mm	900 x 548 mm	DS5313
Console vanity unit wall-mounted Number of drawers: 1, Incl. console: No, Without handle, Soft self-closing automatic with damping, Lay-in compartment Optional, 1000 x 548 mm	1000 x 548 mm	DS5314
Console vanity unit wall-mounted Number of drawers: 2, Incl. console: No, Without handle, Siphon cut-out: Yes, Siphon cover: Yes, Soft self-closing automatic with damping, Lay-in compartment Optional, 800 x 548 mm	800 x 548 mm	DS5317
Console vanity unit wall-mounted Number of drawers: 2, Incl. console: No, Without handle, Siphon cut-out: Yes, Siphon cover: Yes, Soft self-closing automatic with damping, Lay-in compartment Optional, 900 x 548 mm	900 x 548 mm	DS5318
Console vanity unit wall-mounted Number of drawers: 2, Incl. console: No, Without handle, Siphon cut-out: Yes, Siphon cover: Yes, Soft self-closing automatic with damping, Lay-in compartment Optional, 1000 x 548 mm	1000 x 548 mm	DS5319
Console vanity unit wall-mounted Number of drawers: 1, Incl. console: No, Without handle, Soft self-closing automatic with damping, Tip-on fitting, Interior system Optional, 820 x 547 mm	820 x 547 mm	LC5812
Console vanity unit wall-mounted Number of drawers: 1, Incl. console: No, Without handle, Soft self-closing automatic with damping, Tip-on fitting, Interior system Optional, 920 x 547 mm	920 x 547 mm	LC5813
Console vanity unit wall-mounted Number of drawers: 1, Incl. console: No, Without handle, Soft self-closing automatic with damping, Tip-on fitting, Interior system Optional, 1020 x 547 mm	1020 x 547 mm	LC5814
Console vanity unit wall-mounted Number of drawers: 2, Incl. console: No, Without handle, Siphon cut-out: Yes, Siphon cover: Yes, Soft self-closing automatic with damping, Tip-on fitting, Interior system Optional, 820 x 547 mm	820 x 547 mm	LC5817
Console vanity unit wall-mounted Number of drawers: 2, Incl. console: No, Without handle, Siphon cut-out: Yes, Siphon cover: Yes, Soft self-closing automatic with damping, Tip-on fitting, Interior system Optional, 920 x 547 mm	920 x 547 mm	LC5818
Console vanity unit wall-mounted Number of drawers: 2, Incl. console: No, Without handle, Siphon cut-out: Yes, Siphon cover: Yes, Soft self-closing automatic with damping, Tip-on fitting, Interior system Optional, 1020 x 547 mm	1020 x 547 mm	LC5819
Console vanity unit wall-mounted Number of drawers: 2, Incl. console: No, Without handle, Siphon cut-out: Yes, Siphon cover: Yes, Soft self-closing automatic with damping, Tip-on fitting, Interior lighting: Optional, Interior system Optional, 1000 x 550 mm	1000 x 550 mm	HP4961

Console vanity unit wall-mounted Number of drawers: 2, Incl. console: No, Without handle, Siphon cut-out: Yes, Siphon cover: Yes, Soft self-closing automatic with damping, Tip-on fitting, Interior lighting: Optional, Interior system Optional, 1300 x 550 mm	1300 x 550 mm	HP4962
Console vanity unit wall-mounted Number of drawers: 4, Incl. console: No, Without handle, Siphon cut-out: Yes, Siphon cover: Yes, Soft self-closing automatic with damping, Tip-on fitting, Interior lighting: Optional, Interior system Optional, 1600 x 550 mm	1600 x 550 mm	HP4963 L/R
Console vanity unit wall-mounted Number of drawers: 4, Incl. console: No, Without handle, Siphon cut-out: Yes, Siphon cover: Yes, Soft self-closing automatic with damping, Tip-on fitting, Interior lighting: Optional, Interior system Optional, 1600 x 550 mm	1600 x 550 mm	HP4964 B
Console Number of cut-outs: 1, Tap hole drillings possible, Incl. console supports: No, 800 x 550 mm	800 x 550 mm	DS102C
Console Number of cut-outs: 2, Tap hole drillings possible, Incl. console supports: No, 800 x 550 mm	800 x 550 mm	DS103C
Console Number of cut-outs: 1, Tap hole drillings possible, Incl. console supports: No, 800 x 550 mm	800 x 550 mm	DS106C
Console Number of cut-outs: 2, Tap hole drillings possible, Incl. console supports: No, 800 x 550 mm	800 x 550 mm	DS107C
Console Number of cut-outs: 1, Number of washing areas: 1, Tap hole drillings possible, Incl. console supports: No, 800 x 550 mm	800 x 550 mm	LC102C
Console Number of cut-outs: 2, Number of washing areas: 2, Tap hole drillings possible, Incl. console supports: No, 800 x 550 mm	800 x 550 mm	LC103C
Console Number of cut-outs: 1, Number of washing areas: 1, Tap hole drillings possible, Incl. console supports: No, 800 x 550 mm	800 x 550 mm	LC106C
Console Number of cut-outs: 2, Number of washing areas: 2, Tap hole drillings possible, Incl. console supports: No, 800 x 550 mm	800 x 550 mm	LC107C
Recommended faucets		
Single lever basin mixer M Ceramic cartridge, Height: 175 mm, Projection: 113 mm, Spray mode: Normal spray, Aerator adjustable, recommended operating pressure: 1 - 5 bar, Noise class: I, Handle version: lever handle, 143 x 46 mm	143 x 46 mm	C11020001
Single lever basin mixer M Chrome, Ceramic cartridge, Height: 170 mm, Projection: 139 mm, Spray mode: Normal spray, Aerator adjustable, Temperature limit adjustable, recommended operating pressure: 1 - 5 bar, Noise class: I, Handle version: lever handle, 175 x 41 mm	175 x 41 mm	B11020001
Single lever basin mixer M Chrome, Ceramic cartridge, Height: 165 mm, Projection: 138,5 mm, Spray mode: Normal spray, Aerator adjustable, Temperature limit adjustable, recommended operating pressure: 1 - 5 bar, Noise class: I, Handle version: lever handle, 175 x 41 mm	175 x 41 mm	B21020001

Single lever basin mixer L Ceramic cartridge, Height: 262 mm, Projection: 136 mm, Spray mode: Normal spray, Aerator adjustable, recommended operating pressure: 1 - 5 bar, Noise class: I, Handle version: lever handle, 165 x 41 mm	165 x 41 mm	C11030001
Single lever basin mixer Ceramic cartridge, Height: 74 mm, Spray mode: Normal spray, Aerator adjustable, Including trim parts, recommended operating pressure: 1 - 5 bar, Noise class: I, Handle version: lever handle, Unified Water Label (UWL) Class: 1, 173 x 174 mm	173 x 174 mm	C11070003
Single lever basin mixer Ceramic cartridge, Height: 74 mm, Water connection: Basic Set, Spray mode: Normal spray, Aerator adjustable, Including trim parts, recommended operating pressure: 1 - 5 bar, Noise class: I, Handle version: lever handle, Unified Water Label (UWL) Class: 1, 173 x 225 mm	173 x 225 mm	C11070004

All drawings contain the necessary measurements which are subject to standard tolerances. They are stated in mm and are non-binding. Exact measurements, in particular for customised installation scenarios, can only be taken from the finished piece.