

**D-Code Built-in basin # 0338560000**

| &lt; 560 mm &gt; |

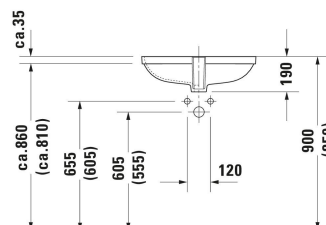
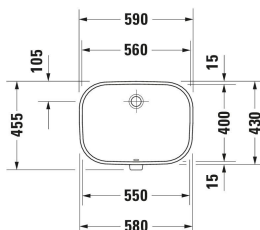

Built-in basin	Dimension	Weight	Order number
Washbasin version: Installation, 560x400 mm, Internal dimensions: 550x400 mm, Tap hole platform: No, Overflow: Yes, Type of mounting: undercounter, Incl. fixings for installation in wooden consoles			
<b>Colors</b>			
00 White Alpin			
<b>Variant</b>			
☒ Washbasin version: undercounter, 560x430 mm, White High Gloss	560x430 mm	9.400 kg	0338560000
<b>Accessory</b>			
Push-open waste Suitable for washbasin with overflow, Ø 63,5 mm	Ø 63.5 mm	0.34 kg	005052
Fixation Type of installation: In natural stone console, Suitable for Built-in basin	10 x 40 mm	0.2 kg	005028
<b>Recommended faucets</b>			
Single lever basin mixer L Ceramic cartridge, Height: 262 mm, Projection: 136 mm, Spray mode: Normal spray, Aerator adjustable, recommended operating pressure: 1 - 5 bar, Noise class: I, Handle version: lever handle, 165 x 41 mm	165 x 41 mm		C11030001
Single lever basin mixer XL Ceramic cartridge, Height: 322 mm, Projection: 166 mm, Spray mode: Normal spray, Aerator adjustable, recommended operating pressure: 1 - 5 bar, Noise class: I, Handle version: lever handle, 197 x 41 mm	197 x 41 mm		C11040001
Single lever basin mixer Ceramic cartridge, Height: 74 mm, Spray mode: Normal spray, Aerator adjustable, Including trim parts, recommended operating pressure: 1 - 5 bar, Noise class: I, Handle version: lever handle, Unified Water Label (UWL) Class: 1, 173 x 174 mm	173 x 174 mm		C11070003
Single lever basin mixer Ceramic cartridge, Height: 74 mm, Water connection: Basic Set, Spray mode: Normal spray, Aerator adjustable, Including trim parts, recommended operating pressure: 1 - 5 bar, Noise class: I, Handle version: lever handle, Unified Water Label (UWL) Class: 1, 173 x 225 mm	173 x 225 mm		C11070004

All drawings contain the necessary measurements which are subject to standard tolerances. They are stated in mm and are non-binding.

**D-Code Built-in basin # 0338560000**

**|< 560 mm >|**

*Exact measurements, in particular for customised installation scenarios, can only be taken from the finished piece.*