

**D-Code Built-in basin # 0337540000**

| &lt; 545 mm &gt; |

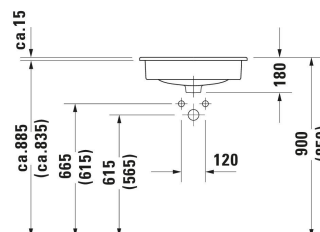
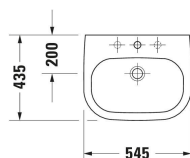

Built-in basin	Dimension	Weight	Order number
Washbasin version: Installation, 545x435 mm, Internal dimensions: 465x275 mm, Tap hole platform: Yes, Overflow: Yes, Type of mounting: counter top			
<b>Colors</b>			
00 White Alpin			
<b>Variant</b>			
● Washbasin version: counter top, White High Gloss, Number of faucet holes per wash area: 1	545x435 mm	11.400 kg	0337540000
<b>Accessory</b>			
Push-open waste Suitable for washbasin with overflow, Ø 63,5 mm	Ø 63.5 mm	0.34 kg	005052
<b>Suitable products</b>			
Console vanity unit wall-mounted Number of drawers: 1, Incl. console: Yes, Tap hole drillings possible, Handle Silver, Soft self-closing automatic with damping, 800 x 550 mm	800 x 550 mm		KT6794
Console vanity unit wall-mounted Number of drawers: 1, Incl. console: Yes, Tap hole drillings possible, Handle Silver, Soft self-closing automatic with damping, 1000 x 550 mm	1000 x 550 mm		KT6795
Console vanity unit wall-mounted Number of drawers: 1, Incl. console: Yes, Tap hole drillings possible, Handle Silver, Soft self-closing automatic with damping, 1200 x 550 mm	1200 x 550 mm		KT6796
Console vanity unit wall-mounted Number of drawers: 2, Incl. console: Yes, Tap hole drillings possible, Handle Silver, Soft self-closing automatic with damping, 1400 x 550 mm	1400 x 550 mm		KT6797 B/L/R
Console vanity unit wall-mounted Number of drawers: 2, Incl. console: Yes, Tap hole drillings possible, Handle Silver, Siphon cut-out: Yes, Siphon cover: Yes, Soft self-closing automatic with damping, 800 x 550 mm	800 x 550 mm		KT6754
Console vanity unit wall-mounted Number of drawers: 2, Incl. console: Yes, Tap hole drillings possible, Handle Silver, Siphon cut-out: Yes, Siphon cover: Yes, Soft self-closing automatic with damping, 1000 x 550 mm	1000 x 550 mm		KT6755

**D-Code Built-in basin # 0337540000**

|&lt; 545 mm &gt;|

Console vanity unit wall-mounted Number of drawers: 2, Incl. console: Yes, Tap hole drillings possible, Handle Silver, Siphon cut-out: Yes, Siphon cover: Yes, Soft self-closing automatic with damping, 1200 x 550 mm	1200 x 550 mm	KT6756
Console vanity unit wall-mounted Number of drawers: 4, Incl. console: Yes, Tap hole drillings possible, Handle Silver, Siphon cut-out: Yes, Siphon cover: Yes, Soft self-closing automatic with damping, 1400 x 550 mm	1400 x 550 mm	KT6757 B/L/R
Console Number of cut-outs: 1, Number of washing areas: 1, Tap hole drillings possible, Incl. console supports: No, 800 x 550 mm	800 x 550 mm	DS828C
Console Number of cut-outs: 2, Tap hole drillings possible, Incl. console supports: No, 800 x 550 mm	800 x 550 mm	DS829C
Console vanity unit wall-mounted Compact, Number of drawers: 1, Incl. console: No, Without handle, Soft self-closing automatic with damping, Lay-in compartment Optional, 700 x 478 mm	700 x 478 mm	DS5301
Console vanity unit wall-mounted Compact, Number of drawers: 1, Incl. console: No, Without handle, Soft self-closing automatic with damping, Lay-in compartment Optional, 800 x 478 mm	800 x 478 mm	DS5302
Console vanity unit wall-mounted Compact, Number of drawers: 1, Incl. console: No, Without handle, Soft self-closing automatic with damping, Lay-in compartment Optional, 900 x 478 mm	900 x 478 mm	DS5303
Console vanity unit wall-mounted Compact, Number of drawers: 1, Incl. console: No, Without handle, Soft self-closing automatic with damping, Lay-in compartment Optional, 1000 x 478 mm	1000 x 478 mm	DS5304
Console vanity unit wall-mounted Number of drawers: 1, Incl. console: No, Without handle, Soft self-closing automatic with damping, Lay-in compartment Optional, 700 x 548 mm	700 x 548 mm	DS5311
Console vanity unit wall-mounted Number of drawers: 1, Incl. console: No, Without handle, Soft self-closing automatic with damping, Lay-in compartment Optional, 800 x 548 mm	800 x 548 mm	DS5312
Console vanity unit wall-mounted Number of drawers: 1, Incl. console: No, Without handle, Soft self-closing automatic with damping, Lay-in compartment Optional, 900 x 548 mm	900 x 548 mm	DS5313
Console vanity unit wall-mounted Number of drawers: 1, Incl. console: No, Without handle, Soft self-closing automatic with damping, Lay-in compartment Optional, 1000 x 548 mm	1000 x 548 mm	DS5314
Console vanity unit wall-mounted Compact, Number of drawers: 1, Incl. console: No, Without handle, Soft self-closing automatic with damping, Tip-on fitting, Interior system Optional, 720 x 477 mm	720 x 477 mm	LC5801
Console vanity unit wall-mounted Compact, Number of drawers: 1, Incl. console: No, Without handle, Soft self-closing automatic with damping, Tip-on fitting, Interior system Optional, 820 x 477 mm	820 x 477 mm	LC5802
Console vanity unit wall-mounted Compact, Number of drawers: 1, Incl. console: No, Without handle, Soft self-closing automatic with damping, Tip-on fitting, Interior system Optional, 920 x 477 mm	920 x 477 mm	LC5803
Console vanity unit wall-mounted Compact, Number of drawers: 1, Incl. console: No, Without handle, Soft self-closing automatic with damping, Tip-on fitting, Interior system Optional, 1020 x 477 mm	1020 x 477 mm	LC5804

**D-Code Built-in basin # 0337540000**

|&lt; 545 mm &gt;|

Console vanity unit wall-mounted Number of drawers: 1, Incl. console: No, Without handle, Soft self-closing automatic with damping, Tip-on fitting, Interior system Optional, 720 x 547 mm	720 x 547 mm	LC5811
Console vanity unit wall-mounted Number of drawers: 1, Incl. console: No, Without handle, Soft self-closing automatic with damping, Tip-on fitting, Interior system Optional, 820 x 547 mm	820 x 547 mm	LC5812
Console vanity unit wall-mounted Number of drawers: 1, Incl. console: No, Without handle, Soft self-closing automatic with damping, Tip-on fitting, Interior system Optional, 920 x 547 mm	920 x 547 mm	LC5813
Console vanity unit wall-mounted Number of drawers: 1, Incl. console: No, Without handle, Soft self-closing automatic with damping, Tip-on fitting, Interior system Optional, 1020 x 547 mm	1020 x 547 mm	LC5814
Console vanity unit wall-mounted Number of drawers: 4, Incl. console: No, Without handle, Siphon cut-out: Yes, Siphon cover: Yes, Soft self-closing automatic with damping, Tip-on fitting, Profile: Chrome, High Gloss, Aluminum, Interior system Optional, 1400 x 548 mm	1400 x 548 mm	XS4916 B
Console vanity unit wall-mounted Number of drawers: 4, Incl. console: No, Without handle, Siphon cut-out: Yes, Siphon cover: Yes, Soft self-closing automatic with damping, Tip-on fitting, Profile: Chrome, High Gloss, Aluminum, Interior system Optional, 1600 x 548 mm	1600 x 548 mm	XS4917 B
Console Number of cut-outs: 1, Tap hole drillings possible, Incl. console supports: No, 800 x 550 mm	800 x 550 mm	DS102C
Console Number of cut-outs: 2, Tap hole drillings possible, Incl. console supports: No, 800 x 550 mm	800 x 550 mm	DS103C
Console Number of cut-outs: 1, Tap hole drillings possible, Incl. console supports: No, 800 x 550 mm	800 x 550 mm	DS106C
Console Number of cut-outs: 2, Tap hole drillings possible, Incl. console supports: No, 800 x 550 mm	800 x 550 mm	DS107C
Console Number of cut-outs: 1, Number of washing areas: 1, Tap hole drillings possible, Incl. console supports: No, 800 x 550 mm	800 x 550 mm	LC102C
Console Number of cut-outs: 2, Number of washing areas: 2, Tap hole drillings possible, Incl. console supports: No, 800 x 550 mm	800 x 550 mm	LC103C
Console Number of cut-outs: 1, Number of washing areas: 1, Tap hole drillings possible, Incl. console supports: No, 800 x 550 mm	800 x 550 mm	LC106C
Console Number of cut-outs: 2, Number of washing areas: 2, Tap hole drillings possible, Incl. console supports: No, 800 x 550 mm	800 x 550 mm	LC107C
Console Compact, Number of cut-outs: 1, Tap hole drillings possible, Incl. console supports: No, 800 x 480 mm	800 x 480 mm	DS100C
Console Compact, Number of cut-outs: 2, Tap hole drillings possible, Incl. console supports: No, 800 x 480 mm	800 x 480 mm	DS101C
Console Compact, Number of cut-outs: 1, Tap hole drillings possible, Incl. console supports: No, 800 x 480 mm	800 x 480 mm	DS104C
Console Compact, Number of cut-outs: 2, Tap hole drillings possible, Incl. console supports: No, 800 x 480 mm	800 x 480 mm	DS105C

**D-Code Built-in basin # 0337540000**

| &lt; 545 mm &gt; |

Console Compact, Number of cut-outs: 1, Number of washing areas: 1, Tap hole drillings possible, Incl. console supports: No, 800 x 480 mm	800 x 480 mm	LC100C
Console Compact, Number of cut-outs: 2, Number of washing areas: 2, Tap hole drillings possible, Incl. console supports: No, 800 x 480 mm	800 x 480 mm	LC101C
Console Compact, Number of cut-outs: 1, Number of washing areas: 1, Tap hole drillings possible, Incl. console supports: No, 800 x 480 mm	800 x 480 mm	LC104C
Console Compact, Number of cut-outs: 2, Number of washing areas: 2, Tap hole drillings possible, Incl. console supports: No, 800 x 480 mm	800 x 480 mm	LC105C
Console vanity unit wall-mounted Number of drawers: 1, Incl. console: Yes, Tap hole drillings possible, Handle, Soft self-closing automatic with damping, Lay-in compartment Optional, 800 x 550 mm	800 x 550 mm	DE4947
Console vanity unit wall-mounted Number of drawers: 1, Incl. console: Yes, Tap hole drillings possible, Handle, Soft self-closing automatic with damping, Lay-in compartment Optional, 1000 x 550 mm	1000 x 550 mm	DE4948
Console vanity unit wall-mounted Number of drawers: 1, Incl. console: Yes, Tap hole drillings possible, Handle, Soft self-closing automatic with damping, Lay-in compartment Optional, 1200 x 550 mm	1200 x 550 mm	DE4949
Console vanity unit wall-mounted Number of drawers: 2, Incl. console: Yes, Tap hole drillings possible, Handle, Siphon cut-out: Yes, Siphon cover: Yes, Soft self-closing automatic with damping, Lay-in compartment Optional, 800 x 550 mm	800 x 550 mm	DE4967
Console vanity unit wall-mounted Number of drawers: 2, Incl. console: Yes, Tap hole drillings possible, Handle, Siphon cut-out: Yes, Siphon cover: Yes, Soft self-closing automatic with damping, Lay-in compartment Optional, 1000 x 550 mm	1000 x 550 mm	DE4968
Console vanity unit wall-mounted Number of drawers: 2, Incl. console: Yes, Tap hole drillings possible, Handle, Siphon cut-out: Yes, Siphon cover: Yes, Soft self-closing automatic with damping, Lay-in compartment Optional, 1200 x 550 mm	1200 x 550 mm	DE4969
<b>Recommended faucets</b>		
Single lever basin mixer M Ceramic cartridge, Height: 175 mm, Projection: 113 mm, Spray mode: Normal spray, Aerator adjustable, recommended operating pressure: 1 - 5 bar, Noise class: I, Handle version: lever handle, 143 x 46 mm	143 x 46 mm	C11020001
Single lever basin mixer M Chrome, Ceramic cartridge, Height: 170 mm, Projection: 139 mm, Spray mode: Normal spray, Aerator adjustable, Temperature limit adjustable, recommended operating pressure: 1 - 5 bar, Noise class: I, Handle version: lever handle, 175 x 41 mm	175 x 41 mm	B11020001
Single lever basin mixer M Chrome, Ceramic cartridge, Height: 165 mm, Projection: 138,5 mm, Spray mode: Normal spray, Aerator adjustable, Temperature limit adjustable, recommended operating pressure: 1 - 5 bar, Noise class: I, Handle version: lever handle, 175 x 41 mm	175 x 41 mm	B21020001

**D-Code Built-in basin # 0337540000**

|< 545 mm >|

<p>Single lever basin mixer L Ceramic cartridge, Height: 262 mm, Projection: 136 mm, Spray mode: Normal spray, Aerator adjustable, recommended operating pressure: 1 - 5 bar, Noise class: I, Handle version: lever handle, 165 x 41 mm</p>	<p>165 x 41 mm</p>	<p>C11030001</p>
<p>Single lever basin mixer M Chrome, Ceramic cartridge, Height: 170 mm, Projection: 139 mm, Water connection: Flexible connecting hoses, 3/8", Spray mode: Normal spray, Aerator adjustable, Temperature limit adjustable, recommended operating pressure: 1 - 5 bar, Noise class: I, Handle version: lever handle, 175 x 41 mm</p>	<p>175 x 41 mm</p>	<p>B11020002</p>

*All drawings contain the necessary measurements which are subject to standard tolerances. They are stated in mm and are non-binding. Exact measurements, in particular for customised installation scenarios, can only be taken from the finished piece.*